

Roche β -Amyloid (1-42), Phospho-Tau and Total-tau

DO NOT FREEZE the CSF under any circumstances

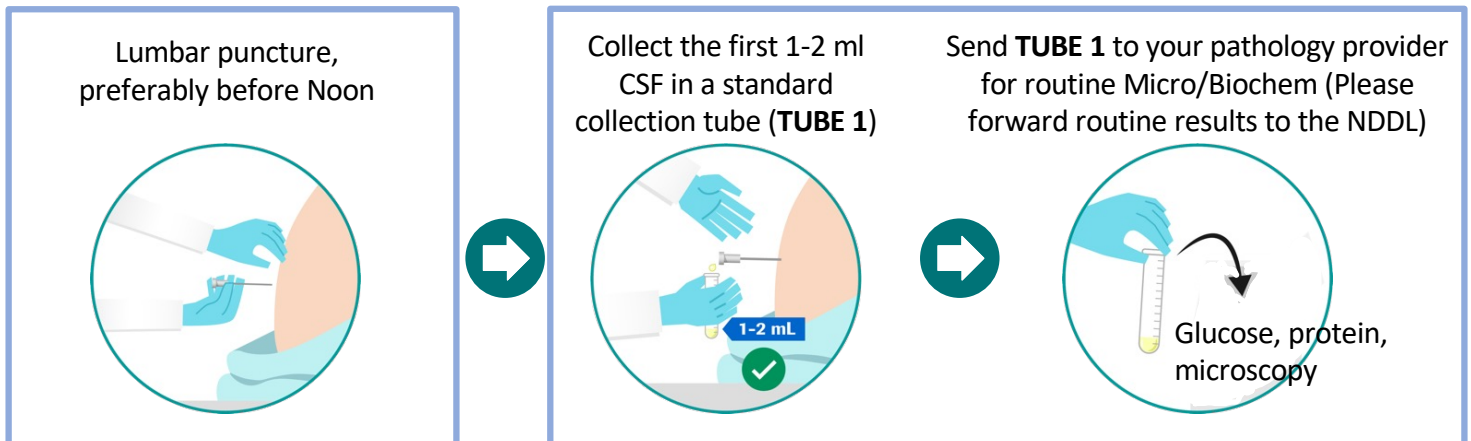

Collect **via gravity drip**. No aspiration or intervening tubing

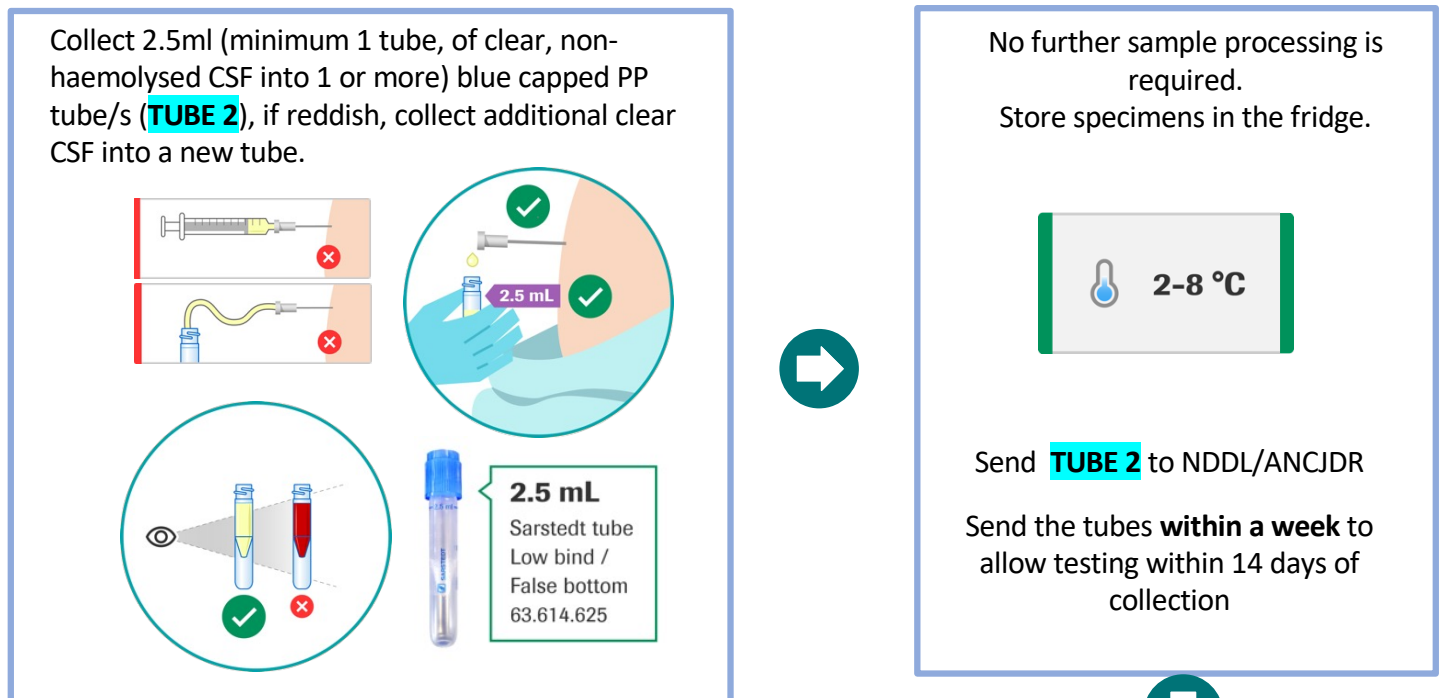

The CSF collected by this process is suitable for following proteins:

Test run weekly:

- ❖ AD test (β -Amyloid (1-42, Phospho-Tau, Total-Tau)
- ❖ CJD test (14-3-3, T-tau, RT-QuIC)

Test run monthly:

Neurofilament light (NfL)

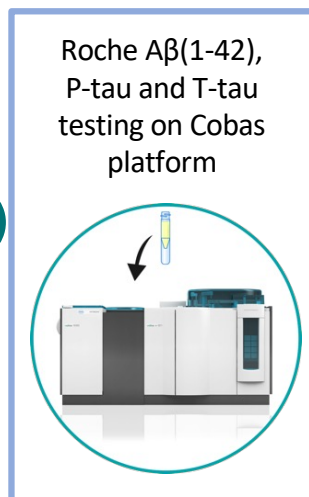

Address samples to:

NDDL / ANCJDR
Florey Institute of Neuroscience,
Kenneth Myer Building, 30 Royal Parade
Gate 11, Rear loading Dock
The University of Melbourne
Parkville, Victoria 3052

Please notify the NDDL/ANCJDR that you are sending the sample:

ancjd-reg@unimelb.edu.au
Ph: 03 83441949 Fax: 03 9349 5105
enquiries-nddl@unimelb.edu.au
Ph: 03 9035 7243 Fax: 03 9349 5105